



TECHNOLOGY MANAGEMENT

MATERIAL LIST

VOICE OVER RS232: TELEPHONE INTERFACE

Author:	Senior Engineer	WJ Bloem
Approved:	Senior Engineer	AJ Britz
Authorised:	Principal Engineer	J Kannemeyer

Date: July 2008

Circulation restricted to:
Transnet Freight Rail and relevant third parties

© This document as a whole is protected by copyright. The information herein is the sole property of Transnet Ltd. It may not be used, disclosed or reproduced in part or in whole in any manner whatsoever, except with the written permission of and in a manner permitted by the proprietors.

Reference	Description	Part Number	Quantity
	Empty printed circuit board	BBC1740 Issue 2.1	1
C25	1nF 50V ceramic capacitor - SM 0805		1
C1, C8	1nF 50V ceramic capacitor - SM 1206		2
C2, C3, C5, C7, C9, C13, C18, C22	0.47uF 50V ceramic capacitor - SM 1206		8
C4	4.7uF 16V ceramic capacitor - SM 1206	KEMET C1206C475K4PAC	1
C6	4.7uF 16V tantalum capacitor - SM 1206		1
C10	0.47uF 63V polyester capacitor – lead pitch 5mm		1
C11, C12	5pF 50V ceramic capacitor - SM 0805		2
C14	150pF 50V ceramic capacitor - SM 0805		1
C15, C27, C28, C29, C30	10uF 10V Tantalum capacitor - SM 1206		5
C16, C17, C20, C23, C26, C31, C32, C33, C34, C37, C38, C39, C40, C41, C42, C48, C49, C51, C52, C53, C54, C55, C56, C58	100nF 50V ceramic capacitor - SM 0805		24
C19	22pF 50V ceramic capacitor - SM 0805		1
C21, C24	4.7nF 50V ceramic capacitor - SM 0805		2
C35, C36	15pF 50V ceramic capacitor - SM 0805		2
C43, C45, C47, C50	100uF 16V electrolytic capacitor radial – lead pitch 2.5mm		4
C44, C57	22uF 100V electrolytic capacitor radial – lead pitch 2.5mm		2
C46	100nF 100V ceramic capacitor - SM 1206		1
R1, R42, R47	100k resistor 1% – SM 0805		3
R2, R17	51k resistor 1% – SM 0805		2
R3, R8, R9, R10, R12, R16, R18, R20, R21, R26, R27, R29, R30, R31, R32, R33, R34, R35, R38, R39, R40, R43, R44, R54, R57	10k resistor 1% – SM 0805		25
R4	12k resistor 1% – SM 0805		1
R5, R22, R24	3K3 resistor 1% – SM 0805		3
R6	24k resistor 1% – SM 0805		1
R7, R41	120k resistor 1% – SM 0805		2
R11, R48	36k resistor 1% – SM 0805		2
R23, R13	47R resistor 1W 1% – SM 2512		2
R14	68k resistor 1% – SM 0805		1
R15	59k resistor 1% – SM 0805		1
R19	18k resistor 1% – SM 0805		1
R25, R53	1M resistor 1% – SM 0805		2
R28	4K7 resistor 1% – SM 0805		1
R45	3M3 resistor 1% – SM 0805		1
R46	20k resistor 1% – SM 0805		1
R49, R52, R56, R58, R67, R68, R69, R70, R72	1k resistor 1% – SM 0805		9
R50, R51, R73	22R resistor 1% – SM 0805		3
R55, R60, R64, R66	1K8 resistor 1% – SM 0805		4
R59, R62, R63, R65, R71	2K2 resistor 1% – SM 0805		5
R61	33k resistor 1% – SM 0805		1
R75	100R resistor 1W 1% – SM 2512		1
U1	Codec for VoIP – SM 64 pin QFP package	ML7204-001GA (OKI)	1
U2	Rslic – 28 pin PLCC	HC55185ECM	1
U3	Rail to rail Opamp – SM 14 pin SOIC narrow	LMC6484AIM	1

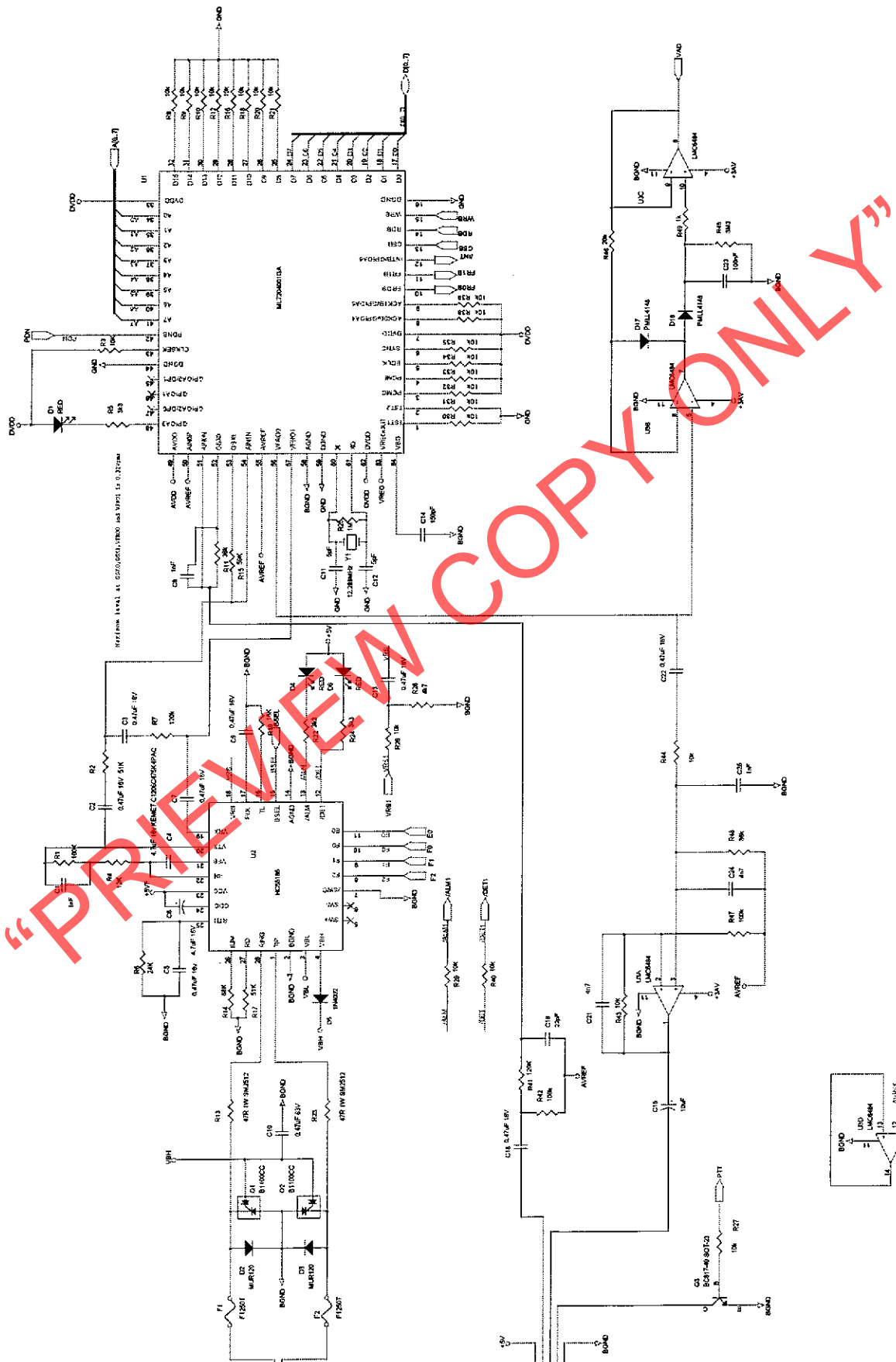

DATE	APPROVED	Technology Management
DESIGNED BY DAMIEN AB	CHECKED BY T.M. SHERIDAN	Version Over RESEZ: Telephone Interface
SPOORNET BIC1728 REV. 1 / 2		

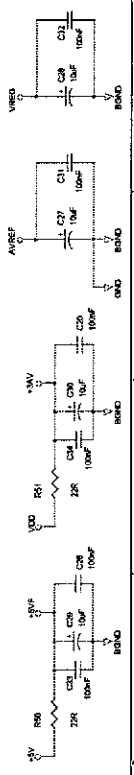



DATE	DESIGNED A.B. DRAWN A.B. CHECKED A.B.	"APPROVED" AUTUMBER	Version Management Value Over REUSE: Telephone Interface
------	---	------------------------	--

SPORNET	BBCT28	TABLE 1	REV. 1 / 1
---------	--------	---------	------------

NOTES

Constructed from extruded Al with a minimum thickness of 0.06" (1.5mm)
 Available in clear or Black anodized finish
 Version 2 includes two Black plastic one piece bezel/panels,
 Hardware and self-adhesive rubber feet included.

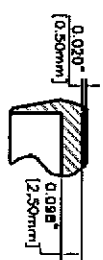
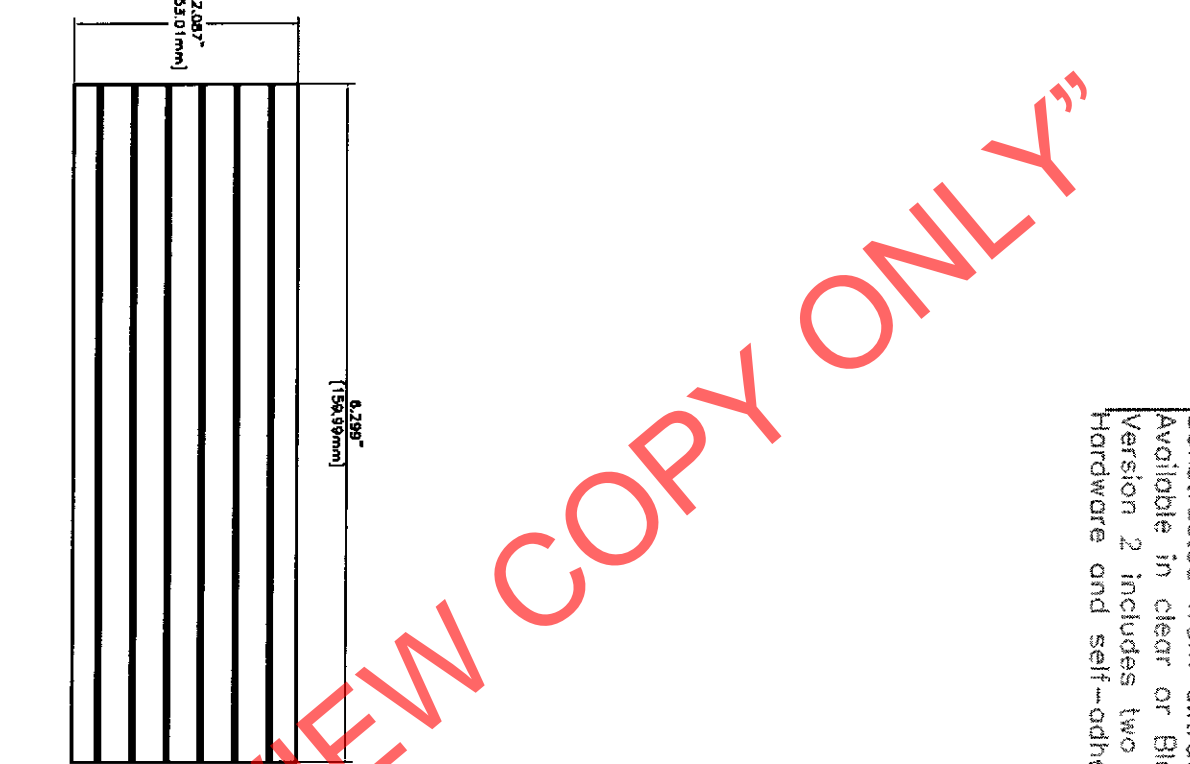
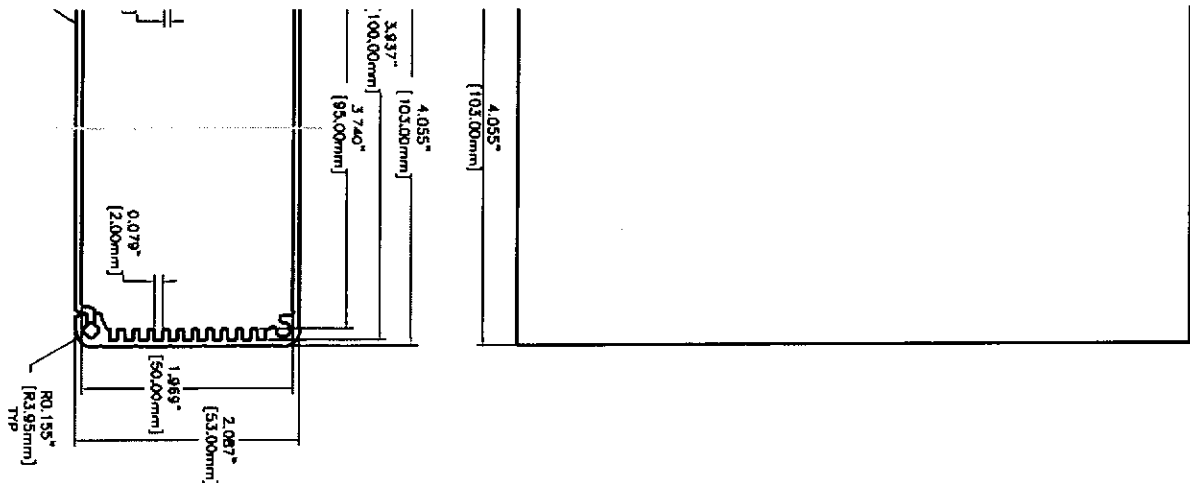

SECTION A-A
SCALE 2:1

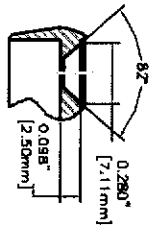

SECTION B-B
SCALE 2:1

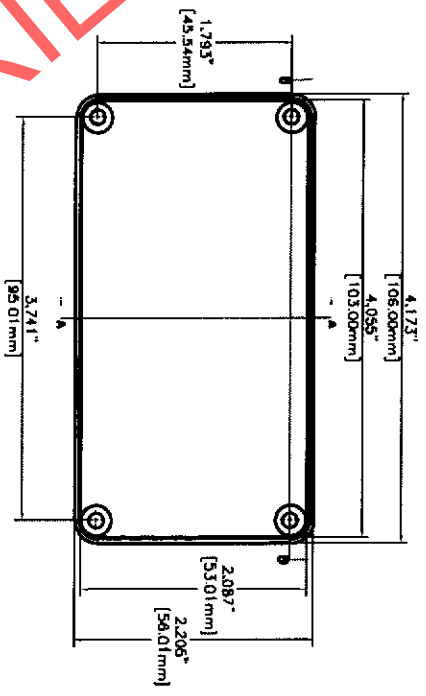

PANEL

EXTRUSION

Use Note is removable.

THIS DRAWING IS PROPRIETARY INFORMATION
 OF HAMMOND MANUFACTURING CO. IT IS TO BE USED
 ONLY FOR THE PROJECT AND NOT TO BE REPRODUCED
 OR TRANSMITTED IN ANY FORM OR BY ANY MEANS
 WITHOUT THE WRITTEN PERMISSION OF HAMMOND

Rev	ECN	Description	Date	By
1	100	REVISED	01 15 02	ML

Units: dimensions specified
 dimensions are in inches
 Tolerances are:
 .X .1
 .XX .02
 .XXX .010
 .XXXX .0005
 Holes .0050
 Angles 2 5

Den	Dr	Date
ML	ML	01 15 02

HAMMOND MANUFACTURING CO., LTD.
 Electronics Group, Waterloo, Ont. - Chesham, NY

HAMMOND 1455 SERIES
EXTRUDED ALUMINUM

Part#: 1455N1502 Dwg: 1455N1502

For the best fit print
 on legal size paper.

NOTES

Constructed from extruded Al with a minimum thickness of 0.06" (1.5mm)
 Available in clear or Black anodized finish
 Version 2 includes two Black plastic one piece bezel/panels.
 Hardware and self-adhesive rubber feet included.

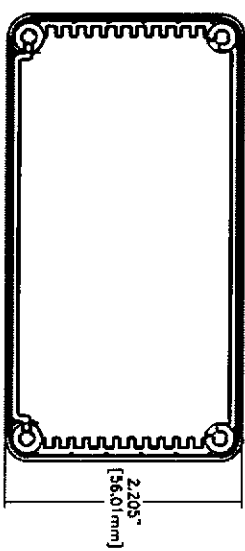
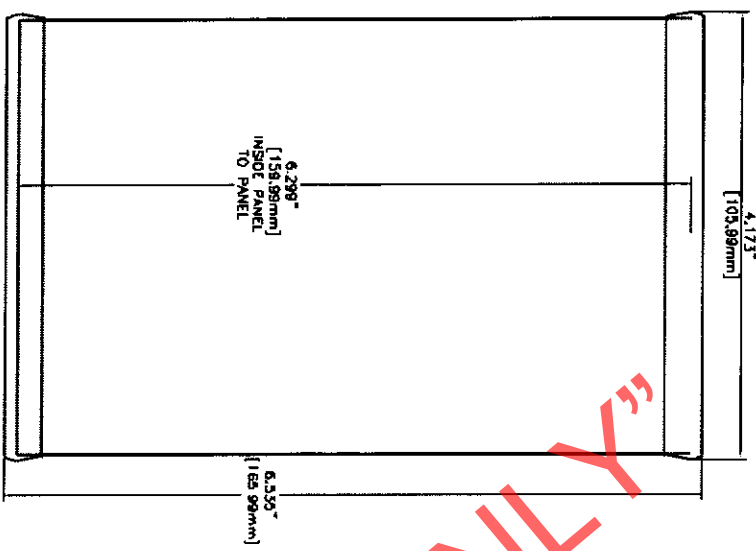

ASSEMBLED



THIS DRAWING IS PROPRIETARY INFORMATION OF HAMMOND MFG CO. AND IS NOT TO BE USED OR COPIED IN ANY MANNER WITHOUT THE WRITTEN PERMISSION OF HAMMOND MFG CO. LTD.

Rev	ECN	Description	Date	By
Δ			01 15 02	AW

UNLESS OTHERWISE SPEC'D	Den	SA	DATE
Dimensions are in inches	1/4	10/15/02	10/15/02
Tolerances over	0.005	0.005	0.005
XXX	0.010	0.010	0.010
XXX	0.015	0.015	0.015
Angles	± 0.05	± 0.05	± 0.05
	± 0.05	± 0.05	± 0.05

For the best fit print on legal size paper.

HAMMOND MANUFACTURING CO., LTD.
 Electronics Group, Waterloo, Ont. - Chesham, NY

HAMMOND 1455 SERIES
 EXTRUDED ALUMINUM

Part#: 455M1502 Dwg: 1455M1502A

RS232 Telephone Front and Rear Bezels
 BBC7729 Issue 1.1

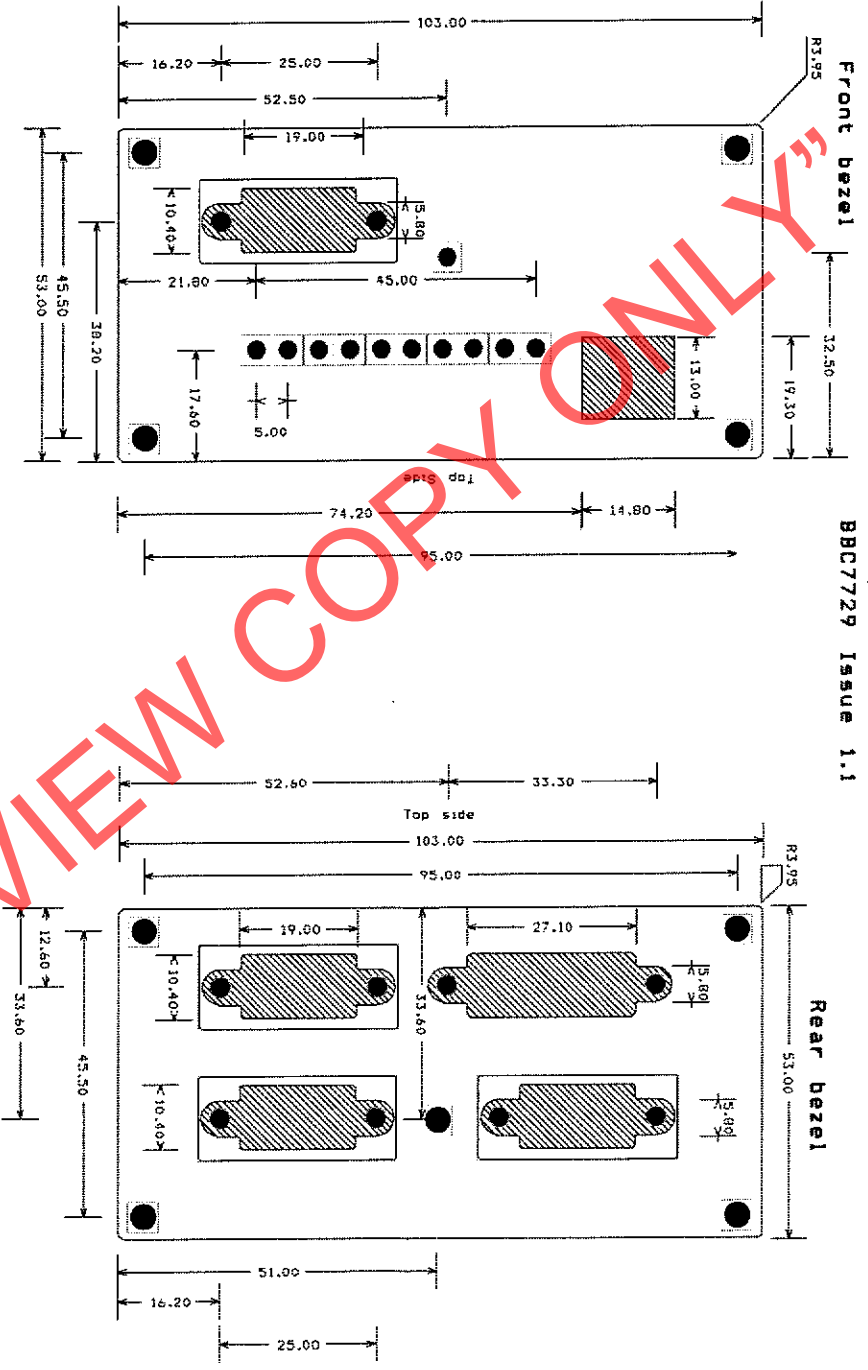

Notes:

- 1) The front and rear plates can be manufactured using 1.5mm thick aluminium or the plastic bezels supplied with the enclosure
- 2) If aluminium is used then the outer dimensions of the plates shall be 53mm±0.03mm. The aluminium shall be black anodised
- 3) Deburred after drilling and machining
- 4) All silk-screening to be done in white on black
- 5) Tolerances: -0.0/+0.1 mm
- 6) All measurements for the plastic bezel are taken from the inside edge of the bezel

HOLE LEGEND			
SYM	DIAM	TOL	QTY
X	5.000 mm		11
o	3.200 mm		10
+	4.000 mm		9
TOTAL			30

“PREVIEW COPY ONLY”

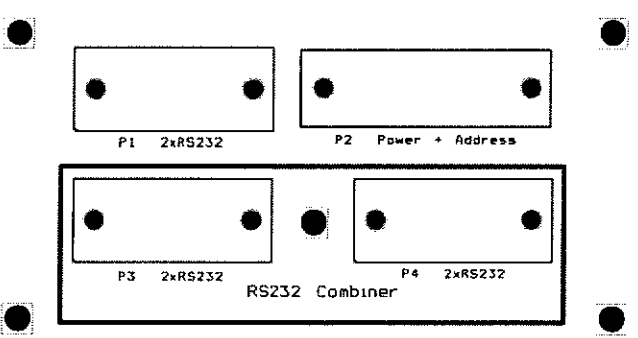
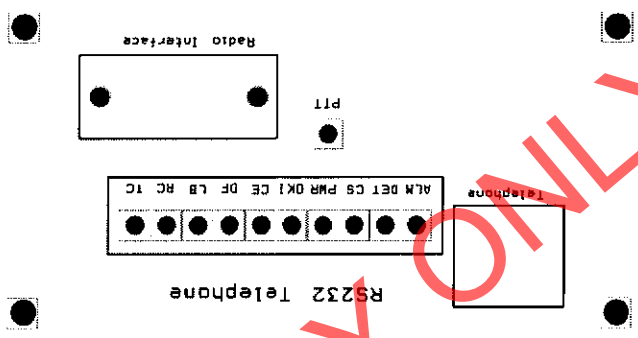

HOLE LEGEND			
SYM	DIAM	TOL	QTY
X	3.000 mm		11
∞	3.200 mm		10
∞	4.000 mm		9
TOTAL			30

NOTE