

Transnet SOC Limited
Transnet RME

REQUEST FOR QUOTATION



TRANSNET FREIGHT RAIL - RME
TFR RFQ BOARD-RME
PROCUREMENT
PORT ELIZABETH

Registration Number: 1990/000900/06
Vat Number : 4720103177

Attention:
Telephone Number :
Fax Number :
Vendor Number :500000

Quotation Deadline Date : 26.11.2013
Quotation Deadline Time : 16.00

REQUEST for QUOTATION
Transnet RME
RFQ Number / Date
6000182102 / 14.11.2013
Contact Person / Telephone
Yandiswa Oldjohn / 021 940 1911
Return to FAX Number/EMAIL
021 8100000 / TCPtendersCapeTown@Transnet.net

PREVIEW COPY

Item	Material	Description	RFQ Qty	JoM	Required Del date	Confirm Del date	Unit Price Excl	Total Price Excl
00010		SUPPLY & INSTALL STORAG		Ac	03.12.2013			

SUPPLY & INSTALL STORAGE RACKS, LOCKABLE RACKS & NORMAL STORAGE RACKS AS PER ATTACHED DRAWING & SPECIFICATIONS

REQUESTER AND DELIVER ADDRESS:

AMANDA TSHANGELA ON 041-5076024

COMPULSORY SITE CLARIFICATION MEETING: 20 NOVEMBER 2013 AT 13H30. TENDERERS TO MEET AT PORT OF NGQURA SECURITY ENTRANCE

CONTACT: AMANDA TSHANGELA ON 041-5076024

COMPLETION DATE TO BE CONFIRMED AT SITE CLARIFICATION MEETING

If you are unable to quote for this enquiry, please submit a NO QUOTE, with a short reason, if possible, for not being able to quote.

Otherwise we look forward to receive your quote by the date and time stated.

Transnet SOC Limited
 Transnet RME
 TRANSNET FREIGHT RAIL - RME
 TFR RFQ BOARD-RME
 PROCUREMENT
 PORT ELIZABETH
 6001

REQUEST FOR QUOTATION



Registration Number: 1990/000900/06
 Vat Number : 4720103177

Attention:
 Telephone Number :
 Fax Number :
 Vendor Number : 500000

Quotation Deadline Date : 26.11.2013
 Quotation Deadline Time : 16.00

REQUEST for QUOTATION
 Transnet RME
RFQ Number / Date
 6000182162 / 14.11.2013
Contact Person / Telephone
 Yandiswa Oldjohn / 021 940 1911
Return to FAX Number/EMAIL
 021 8100000 / TCPtendersCapeTown@Transnet.net

Item	Material	Description	RFQ Qty	UoM	Required Del date	Confirm Del date	Unit Price Excl	Total Price Excl
------	----------	-------------	---------	-----	-------------------	------------------	-----------------	------------------

The item covers the following services:

"PREVIEW COPY"

Transnet SOC Limited
 Transnet RME
 TRANSNET FREIGHT RAIL - RME
 TFR RFQ BOARD-RME
 PROCUREMENT
 PORT ELIZABETH
 6001

REQUEST FOR QUOTATION

Registration Number: 1990/000900/06
 Vat Number : 4720103177

**Attention:**

Telephone Number :
 Fax Number :
 Vendor Number : 500000

Quotation Deadline Date : 26.11.2013
Quotation Deadline Time : 16.00

REQUEST for QUOTATION

Transnet RME

RFQ Number / Date

6000182162 / 14.11.2013

Contact Person / Telephone

Yandiswa Oldjohn / 021 940 1911

Return to FAX Number/EMAIL

021 8100000 / TCPTendersCapeTown@Transnet.net

Delivery Address

TFR RME Cape Town
 De Gatt Complex, Behind Propne
 Bellville South, Cape Tow
 7530

This RFQ is subject to the following conditions:

1. Price/s : The price/s quoted in SA currency and is excluding of V.A.T
2. Delivery : The price/s quoted should include delivery cost to the delivery address stated on the RFQ
3. Returnables : A valid tax clearance certificate and BBBEE certificate from a SANAS accredited verification agency attached to quotation for all quotes above R30 000.
Please note that only the official Transnet RFQ will be accepted and all other correspondence to be attached to the original
4. Safety : To confirm to Transnet Capital Projects Health & Safety plan and specification; HAS-std-0001, copy available on request.
5. Confirmation: To confirm your participation in this tender process please sign and return this document as immediate effect prior to the quotation deadline.
6. Negotiations: The Employer may elect to negotiate the final terms of the contract/order with the preferred tenderer in accordance with Clauses F.2.17 and F.3.13 of the CIDB Standard Conditions of Tender. A copy of which is available upon request.

 Signature

 Date

2163-CI-2620-610 PORT OF ROYAL - CONTAINER TERMINAL CONTAINER TERMINAL - SAPD BUILDING INSPECTION BUILDINGS SHOPPING DRAWINGS		REVISIONS / ISSUE AUTHORIZATION NO. DESCRIPTION DATE BY DATE BY DATE BY		REFERENCE DRAWINGS NO. DESCRIPTION DATE BY	
2163-CI-2620-610 PORT OF ROYAL - CONTAINER TERMINAL CONTAINER TERMINAL - SAPD BUILDING INSPECTION BUILDINGS SHOPPING DRAWINGS		REVISIONS / ISSUE AUTHORIZATION NO. DESCRIPTION DATE BY DATE BY DATE BY		REFERENCE DRAWINGS NO. DESCRIPTION DATE BY	

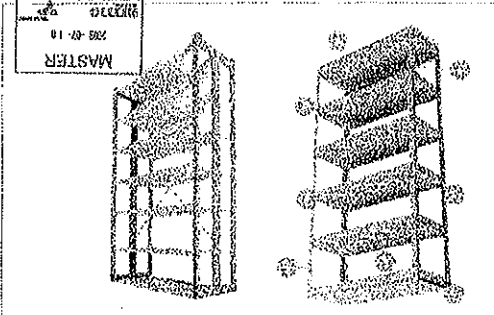

DOUBLE BAY ADJUSTABLE shelving with timber-faced shelves

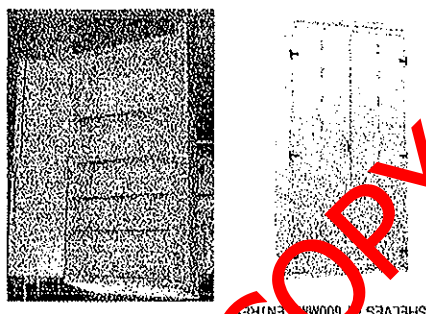

CUSTOM FITTED STEEL CABINETS WITH LOOKABLE DOORS AND SHELVES 6000MM CENTRES

IMPORTANT NOTE: ALL DIMENSIONS BE CHECKED ON SITE PRIOR TO MANUFACTURE AND INSTALLATION



TYPICAL ELEVATION
main material store
SCALE 1:30

2 rows of shelves to be separated by equally spaced stiles

1. free-standing heavy duty adjustable timber-faced shelves to height of 2000mm

2. rows of shelves to be supported by equally spaced stiles

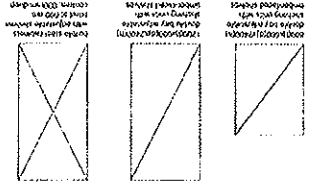

TOOL STORE
Plan 1:50

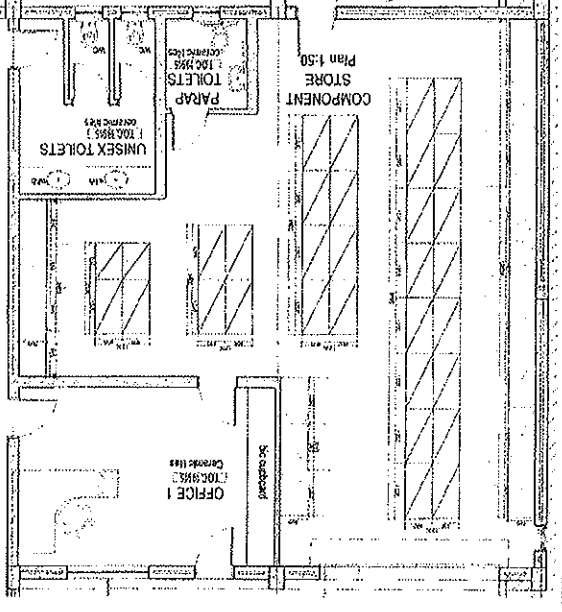

COMPONENT STORE
Plan 1:50

STORE
AREA 2
Plan 1:50

TYPICAL SECTION OF STEEL BIC
SCALE 1:20

PREVIEW COPY ONLY



STORAGE RACKS FOR MEZZANINE FLOOR AT THE PORT OF NGQOURA

- Supply and install 107 storage racks with the following dimensions, 600mm x 1200mm x 2400mm as per the drawing.
 - 8 of the 107 storage racks must be designed specifically for the storing of bolts and nuts and other small items.
 - 15 of the 107 storage racks and these racks must be lockable.
 - 84 of the 107 storage racks must be normal standard storage racks

PREVIEW COPY ONLY