



Transnet SOC Limited
Transnet RME

REQUEST FOR QUOTATION

TFR RME RFQ BOARD
TRANSNET FREIGHT RAIL RME
XXXXXXXXXXXX
XXXXXXXXXXXXXXXXXXXX

Registration Number: 1990/000900/06
Vat Number : 4720103177

Attention:
TFR RME RFQ BOARD
Telephone Number :
Fax Number :
Vendor Number :500000

Quotation Deadline Date : 12.09.2013
Quotation Deadline Time : 16H00

REQUEST for QUOTATION
Transnet RME
RFQ Number / Date
6000173149 / 04.09.2013
Contact Person / Telephone
Anne Mongie / 031 361 1759
Return to / FAX Number/EMAIL
0318300001 / TCPtendersDurban@Transnet.net

Item	Material	Description	RFQ Qty	UoM	Required Del date	Confirm Del date	Unit Price Excl	Total Price Excl
00010		Supply And Fit Reinforc	28	kg	18.09.2013			

Supply And Fit Reinforcing For 12m Mast as per drawing
As and when required

DELIVERY : PORT ELIZABETH STATION

Contact person : Clinton 0761636371

QUOTATION DEADLINE : 12 SEPTEMBER 2013 AT 16H00.
QUOTES MUST BE SENT TO : TCPtendersDurban@transnet.net or :
faxed to 0318300001
ATTACH COPIES OF BBBE AND TAX CLEARANCE CERTIFICATES.
ALL PROCUREMENT RELATED QUERIES TO BE DIRECTED TO :
ANNE MONGIE 031 361 1759.

PREVIEW COPY



Transnet SOC Limited
 Transnet RME
 TFR RME RFQ BOARD
 TRANSNET FREIGHT RAIL RME
 XXXXXXXXXXXX
 XXXXXXXXXXXXXXXXXXXX
 0000

REQUEST FOR QUOTATION

Registration Number: 1990/000900/06
 Vat Number : 4720103177

Attention:
 TFR RME RFQ BOARD
 Telephone Number :
 Fax Number :
 Vendor Number :500000

Quotation Deadline Date : 12.09.2013
Quotation Deadline Time : 16H00

REQUEST for QUOTATION
 Transnet RME
RFQ Number / Date
 6000173149 / 04.09.2013
Contact Person / Telephone
 Anne Mongie / 031 361 1759
Return to V/A Number/EMAIL
 031800000 / TCPtendersDurban@Transnet.net

Delivery Address
 TFR RME Durban
 100 Eel Road
 Bayhead, Durban
 4001

This RFQ is subject to the following conditions:

1. Price/s : The price/s quoted in SA currency and is excluding of V.A.T.
2. Delivery : The price/s quoted should include delivery cost to the delivery address stated on the RFQ
3. Returnables : A valid tax clearance certificate and BBBEE certificate from a SANAS accredited verification agency attached to quotation for all quotes above R30 000.
 Please note that only the official Transnet RFQ will be accepted and all other correspondence to be attached to the original
4. Safety : To confirm to Transnet Capital Projects Health & Safety plan and specification; HAS-std-0001, copy available on request.
5. Confirmation: To confirm your participation in this tender process please sign and return this document as immediate effect prior to the quotation deadline.
6. Negotiations: The Employer may elect to negotiate the final terms of the contract/order with the preferred tenderer in accordance with Clauses F.2.17 and F.3.13 of the CIDB Standard Conditions of Tender. A copy of which is available upon request.

Signature _____

Date _____

"PRELIMINARY COPY"



SECTIONAL POLES

A division of Harrison & White
Investments (Pty) Ltd
REG. NO. 2009/028372/07

Drawing Number

FD-100.pdf

Mast/Structure Description: 15m Sc Mast, 4x400W, Cat2, Hasl:0m

Bending Moment (ULS):	33.9 kNm	Concrete Volume:	1.3 m ³
Shear Force (ULS):	4.3 kN	Concrete Strength:	25 MPa
Structure Mass:	374.9 kg	Reinforcement Mass:	77.9 kg
Applied vertical force (ULS):	0.0 kN	Reinforcement Strength:	450 MPa
Required Soil Pressure:	142.5 kPa	Excavation Volume:	2.8 m ³
		Backfill Volume:	1.6 m ³

Handwritten: Ba. H. S. C. C. L. R.
02/04/12

ISSUED FOR CONSTRUCTION

Site Name: Lehlotla

Ref. no. 29423 Date: 4/6/12

Signature: [Signature]

Shape codes and dimensions of steel reinforcement according to SABS 82:

Ref.	Quantity		Diameter		Full Length		B	Shape Code
	Top	Bottom	Top	Bottom	Top	Bottom		
a1	4	4	12	12	1894	1894	1634	C=1607
a2	4	4	12	12	1755	1755	1490	
a3	4	4	12	12	1430	1430	1100	
a4	4	4	12	12	504	504	240	
b		8		16		1251		A=190 B=1101
c		4		10		1907		A, B=470
d		8		16		1409		A, C, D=422 B=152

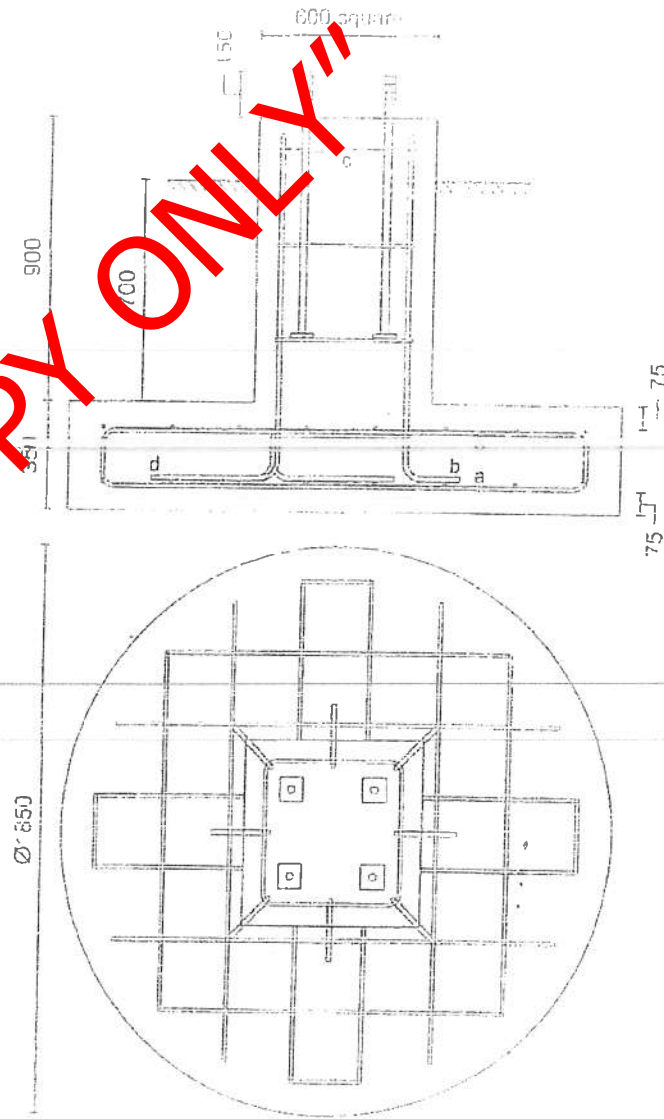

Notes:

1. Foundation Bolts per Plynth. 4x M24 Plate, 280 mm Square, UTS 550 MPa min. fixing templates to be placed at top and bottom of bolts before casting
2. Positioning of stools (Ref. d) to be determined on site to provide sufficient support between Top and Bottom bars (Ref. a)
3. Bottom and top reinforcement mats each consist of 8 x 8 bars at 232 mm spacing