

REQUEST FOR QUOTATION

Transnet SOC Limited
T/A Transnet Capital Projects

TRANSNET FREIGHT RAIL - RME
TFR RFQ BOARD-RME
PROCUREMENT DEPARTMENT
PORT ELIZABETH

Registration Number: 1990/000900/06
Vat Number : 4720103177

REQUEST for QUOTATION

Transnet Capital Projects
RFQ Number / Date
6000169438 / 02.08.2013
Contact Person / Telephone
Yandiswa Oldjohn / 021 940 1886
Return to VAX Number/EMAIL
0218100000 / TCPtendersCapeTown@Transnet.net

Attention:

Telephone Number :
Fax Number :
Vendor Number :500000

Quotation Deadline Date : 14.08.2013
Quotation Deadline Time : 16:00

Item	Material	Description	RFQ Qty	UoM	Required Del date	Confirm Del date	Unit Price Excl	Total Price Excl
100010		Flooring, Recarpeting &	1	Ac	120.08.2013			

Flooring, Recarpeting & carpeting of TNPA as per attached Bill of Quantities and drawings

REQUESTER AND DELIVRY ADDRESS:

Ferreira-Transnet Freight Rail

COMPULSORY SITE CLARIFICATION MEETING: 8 AUGUST 2013 AT 10H00. SUPPLIERS TO MEET AT BREAK EVEN CAFE IN THE PORT OF PORT ELIZABETH

CONTACT DANIE FERREIRA ON 083-778-1693

If you are unable to quote for this enquiry, please submit a NO QUOTE, with a short reason, if possible, for not being able to quote.

Otherwise we look forward to receive your quote by the date and time stated

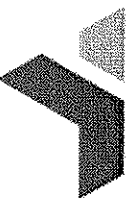

REQUEST FOR QUOTATION

Transnet SOC Limited
T/A Transnet Capital Projects
 TRANSNET FREIGHT RAIL - RME
 TFR RFQ BOARD-RME
 PROCUREMENT DEPARTMENT
 PORT ELIZABETH
 6001

Registration Number: 1990/000900/06
 Vat Number : 4720103177

Attention:
 Telephone Number :
 Fax Number :
 Vendor Number : 500000

Quotation Deadline Date : 14.08.2013
Quotation Deadline Time : 16:00

REQUEST for QUOTATION
 Transnet Capital Projects
RFQ Number / Date
 6000169438 / 02.08.2013
Contact Person / Telephone
 Yandiswa Oldjohn / 021 940 1886
Return to VAX Number/EMAIL
 0218100000 / TCPlendersCapeTown@Transnet.net

Item	Material	Description	RFQ Qty	UoM	Required Del date	Confirm Del date	Unit Price Excl	Total Price Excl
------	----------	-------------	---------	-----	-------------------	------------------	-----------------	------------------

The item covers the following services:

Delivery Address
 TRANSNET FREIGHT RAIL - RME
 Port of Port Elizabeth
 PORT ELIZABETH
 6001

- This RFQ is subject to the following conditions:
1. **Prices/** : The prices/ quoted in SA currency and is excluding of V.A.T
 2. **Delivery** : The prices/ quoted should include delivery cost to the delivery address stated on the RFQ.
 3. **Returnables** : A valid tax clearance certificate and BBBEE certificate from a SANAS accredited verification agency attached to quotation for all quotes above R30 000.
 Please note that only the official Transnet RFQ will be accepted and all other correspondence to be attached to the original
 4. **Safety** : To confirm to Transnet Capital Projects Health & Safety plan and specification; HAS-std-0001, copy available on request.
 5. **Confirmation:** To confirm your participation in this tender process please sign and return this document as immediate effect prior to the quotation deadline.
 6. **Negotiations:** The Employer may elect to negotiate the final terms of the contract/order with the preferred tenderer in accordance with Clauses F.2.17 and F.3.13 of the CIDB Standard Conditions of Tender. A copy of which is available upon request.

Signature _____

Date _____

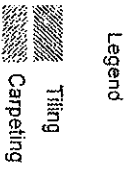
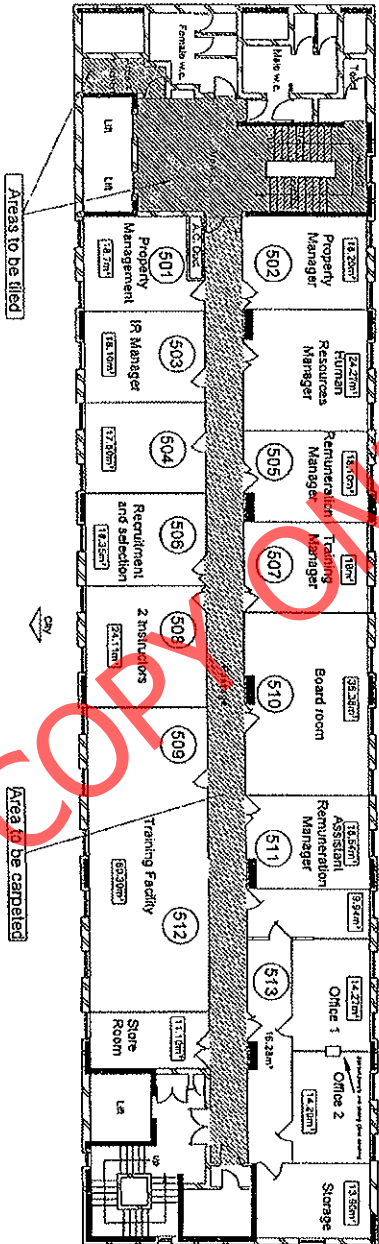

"PREVIEW COPY"

NOTES

1. New work shown in red
2. Areas to be tiled all shown with red borders and hatched
3. Area 1 = 25m²
4. Area 2 = 5.2m²
5. Area 3 = 16.7m²
6. Area 4 = 4.5m²
7. Passage Area = 58m²
8. Passage Area to be re-carpeted

Designation	Date	Signature
Port Manager		
HR Manager		
Property Manager		

No	Amendments	Date	Approved

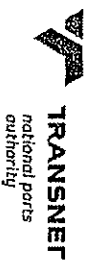

Port of Port Elizabeth
Port Administration Building

5th Floor Proposed Re-tiling
and Re-Carpeting

Project Manager

Port Engineer

Date	1 : 1000	PEH	51
Designed	A.N.S	File	0
Drawn	A.N.S	Date	2013-04-29
Checked	W.C.E.	Sheet	12
Amendments	0	A3	PEH51A0825-12-00

"PREVIEW COPY ONLY"

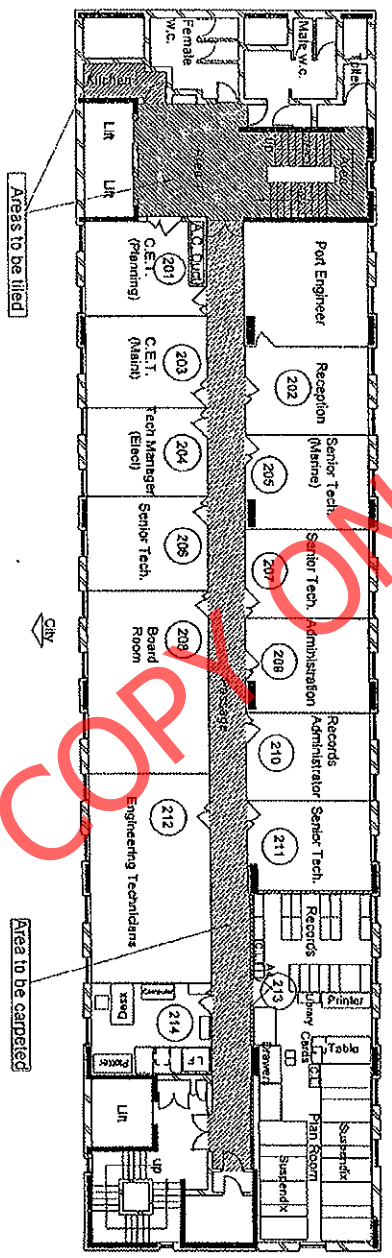

Legend

Tiling

Carpeting



- Notes**
1. New work shown in red
 2. Areas to be tiled all shown with red borders and hatched
 3. Area 1 = 25m²
 4. Area 2 = 52m²
 5. Area 3 = 12m²
 6. Area 4 = 4.5m²
 7. Passage to be Carpeted
 8. Passage Area = 58m²

Designation	Date	Signature
Port Manager		
No. Amendments	Date	Approved



Port of Port Elizabeth

Port Administration Building

2nd Floor: Proposed Re-tiling and Re-Carpeting

Project Manager		Port Engineer	
Date		Date	
Designed	A.N.S. Scale	1:200	PEH 51
Drawn	A.N.S. File	L4726/324	O 822
Checked	W.C.E. Date	2013-04-29	Sheet 11
Amendments	0	A3	PEH51A0822-11-00

"PREVIEW COPY ONLY"

- Legend**
- Tiling
 - Carpeting

3rd Floor plan

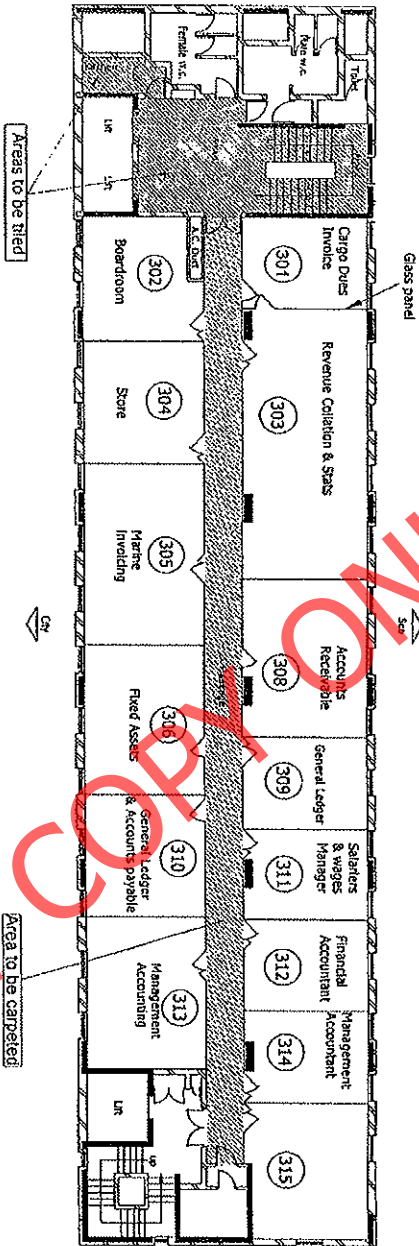

Notes

1. New work shown in red
2. Areas to be tiled all shown with red borders and hatched
3. Area 1 = 25m²
4. Area 2 = 5,2m²
5. Area 3 = 12m²
6. Area 4 = 4,5m²
7. Passage Area to be Carpeted
8. Passage Area = 58m²

Designation	Date	Signature
Port Manager		
Finance Manager		

No	Amendments	Date	Approved



Port of Port Elizabeth
Port Administration Building

3rd Floor : Proposed Re-Tiling
and Re-Carpeting

Date _____		Date _____	
Project Manager _____		Port Engineer _____	
Designed	A.N.S	Scale	1 : 200
Drawn	A.N.S	File	W4/55/1/3rd
Checked	W.C.E	Date	2013-04-30
Amendments	0	A3	PEH5100823-17-00
		Sheet	17
			51
			823

"PREVIEW COPY ONLY"

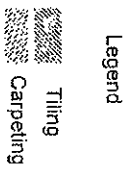
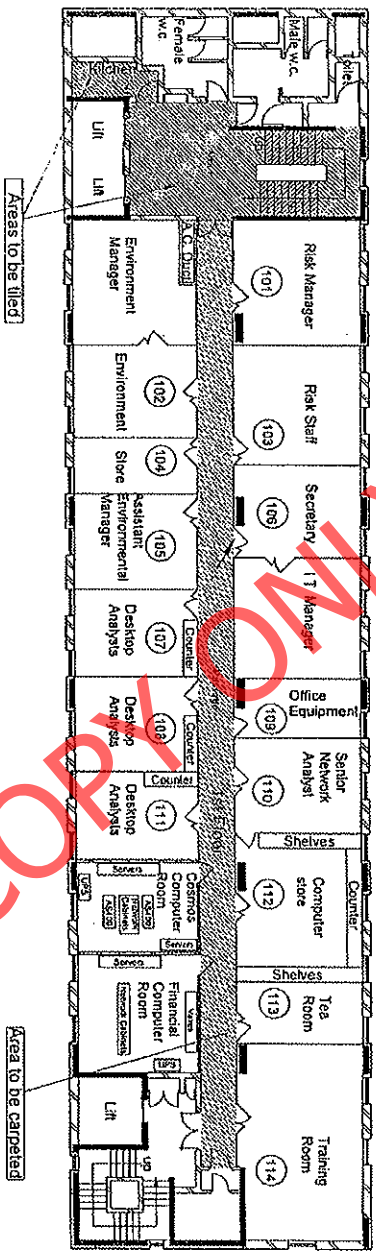

- Notes**
1. New work shown in red
 2. Areas to be tiled all shown with red borders and hatched
 3. Area 1 = 25m²
 4. Area 2 = 3.2m²
 5. Area 3 = 16.7m²
 6. Area 4 = 4.5m²
 7. Passage Area to be Carpeted
 8. Passage Area = 58m²

Designation	Date	Signature
Port Manager		
I.T. Manager		
No. Amendments	Date	Approved



Port of Port Elizabeth
Port Administration Building

1st Floor : Proposed Re-Tiling
and Re-Carpeting

Project Manager		Date		Port Engineer	
Designed	A.N.S	Scale	1 : 200	PEH	51
Drawn	A.N.S	File	L4/26/324	O	821
Checked	W.C.E	Date	2013-04-30	Sheet	11
Amendments	0	A3	PEH5100821-11-00		

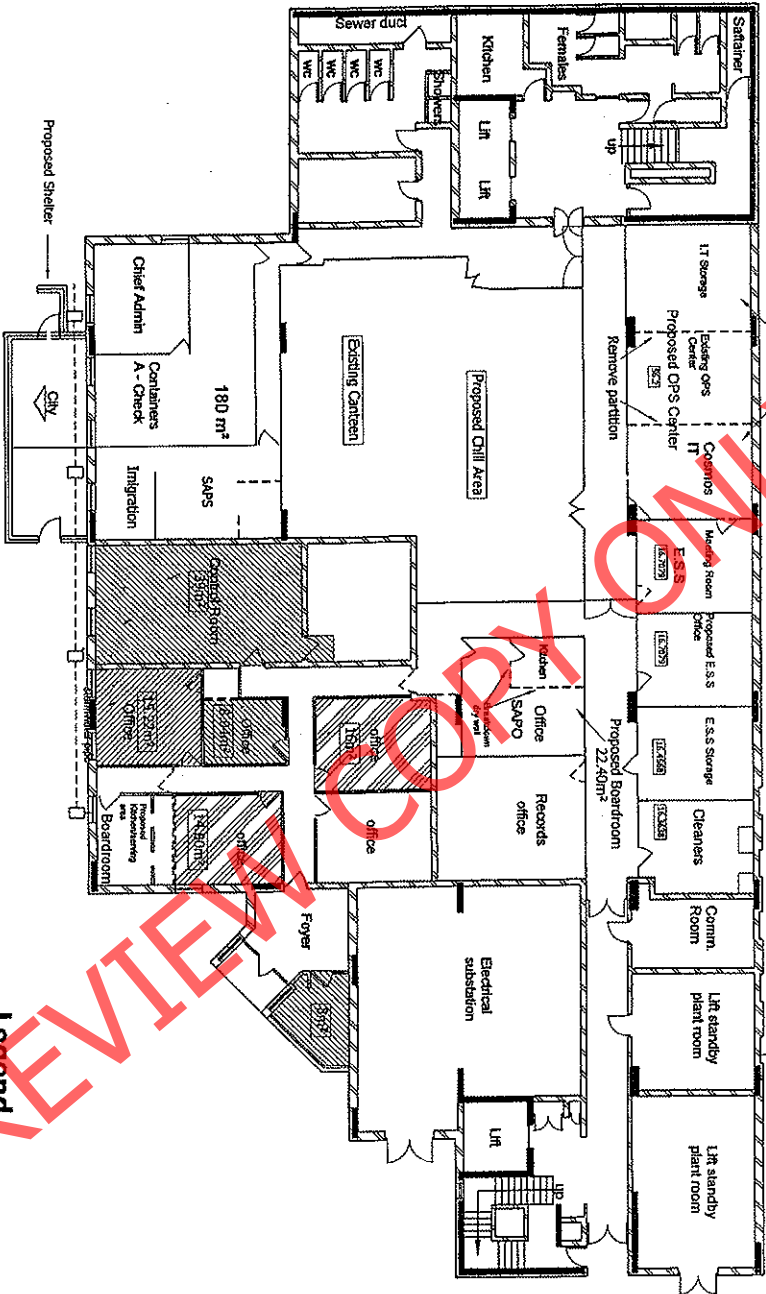

Legend

Convert Tiles to Carpet

Carpets

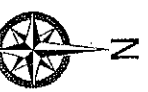

NOTES

Designation	Date	Signature	
Port Manager			
Acting Senior OPS Manager			
Security Manager			
Risk Manager			
Property Manager			
No	Amendments	Date	Approved

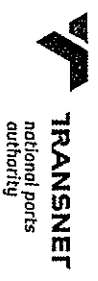

Port of Port Elizabeth

Port Admin building

Proposed Alterations At the Lower Ground: Recarpeting and carpeting of Security Offices

Site plan

Project Manager		Date		Port Engineer	
Date	H.S	Scale	1 : 200	PEH	51
Drawn	A.N.S	File	W4/65/1/L/GF	O	819
Checked	H.S	Date	2013-06-24	Sheet	21
Amendments	0	A3	PEH5100819-21-00		

Ref. no.	Description	Unit	Qty	Rate	Amount
1	Flooring at the TNPA Building				
1.1	Remove existing tiles at foyers, staircases and kitchen	m2	206		
1.2	Supply and fit new tiles at foyers, staircases and kitchen	m2	206		
1.3	Remove existing carpets at passages	m2	232		
1.4	Supply and fit new carpets at passages	m2	232		
2	Recarpeting and carpeting of security offices at lower ground				
2.1	Remove existing caperts at control room & offices	m2	71		
2.2	Supply and fit new carpets at control room & offices	m2	71		
2.3	Remove existing tiles at offices	m2	31		
2.4	Supply and fit new carpets at offices	m2	31		
TOTAL (EXCL. VAT)					

"PREVIEW COPY ONLY"

Ref. no.	Description	Unit	Qty	Rate	Amount
1	Flooring at the TNPA Building				
1.1	Remove existing tiles at foyers, staircases and kitchen	m2	206		
1.2	Supply and fit new tiles at foyers, staircases and kitchen	m2	206		
1.3	Remove existing carpets at passages	m2	232		
1.4	Supply and fit new carpets at passages	m2	232		
2	Recarpeting and carpeting of security offices at lower ground				
2.1	Remove existing caperts at control room & offices	m2	71		
2.2	Supply and fit new carpets at control room & offices	m2	71		
2.3	Remove existing tiles at offices	m2	31		
2.4	Supply and fit new carpets at offices	m2	31		
				TOTAL (EXCL. VAT)	

"PREVIEW COPY ONLY"